

## SBE

Dimensions in mm.  
Other types available on request.

**Material:** N/A



## General Data

| Designation    | Dynamic Load Capacity (N) | Static Load Capacity (N) | Number Of Ball Rows |
|----------------|---------------------------|--------------------------|---------------------|
| <b>SBE16UU</b> | 1530                      | 1280                     | 5                   |
| <b>SBE20UU</b> | 2630                      | 1700                     | 6                   |
| <b>SBE25UU</b> | 3880                      | 2810                     | 6                   |
| <b>SBE30UU</b> | 4810                      | 2860                     | 6                   |
| <b>SBE40UU</b> | 6630                      | 5840                     | 6                   |
| <b>SBE50UU</b> | 11690                     | 8100                     | 6                   |

## Dimensions

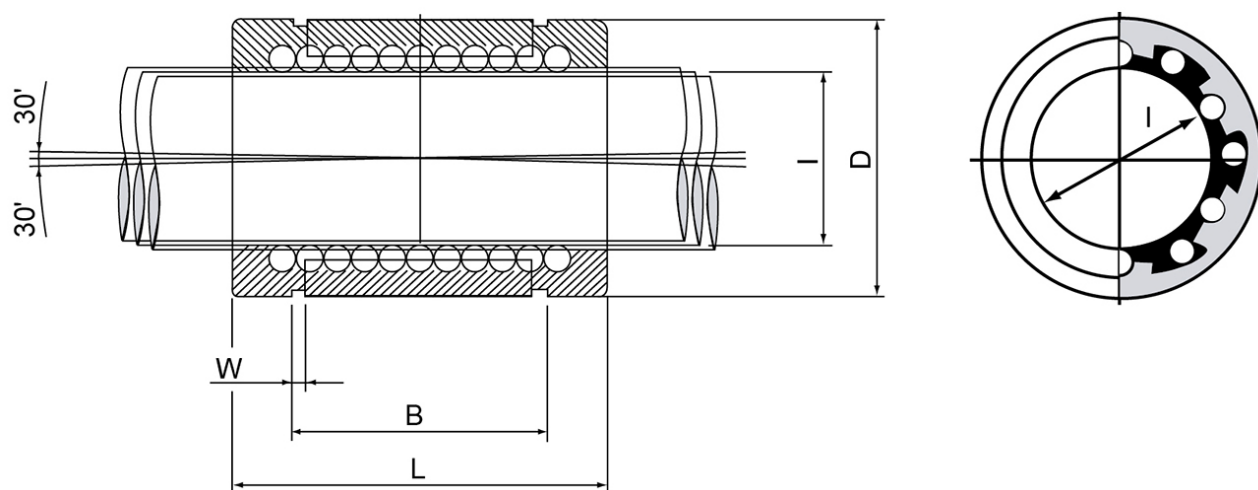

| Designation    | I  | D  | L   | W    | B    |
|----------------|----|----|-----|------|------|
| <b>SBE16UU</b> | 16 | 26 | 36  | 1.3  | 24.6 |
| <b>SBE20UU</b> | 20 | 32 | 45  | 1.6  | 31.2 |
| <b>SBE25UU</b> | 25 | 40 | 58  | 1.85 | 43.7 |
| <b>SBE30UU</b> | 30 | 47 | 68  | 1.85 | 51.7 |
| <b>SBE40UU</b> | 40 | 62 | 80  | 2.15 | 60.3 |
| <b>SBE50UU</b> | 50 | 75 | 100 | 2.65 | 77.3 |