

Adapter Plate for HK Clamping Element

Because of the height difference of different rail guide blocks and to ensure the proper function of the HK Clamping Elements, the use of adapter plates is sometimes needed. See document "Selection of Clamping Elements" for individual block types and whether an adapter plate is needed.

Dimensions in mm.



General Data

| Designation | Weight (kg) |
|-------------|-------------|
| PHK15-4 | 0.033 |
| PHK25-4 | 0.062 |
| PHK30-3 | 0.08 |
| PMK35-7 | 0.2 |
| PHK45-10 | 0.39 |

Dimensions

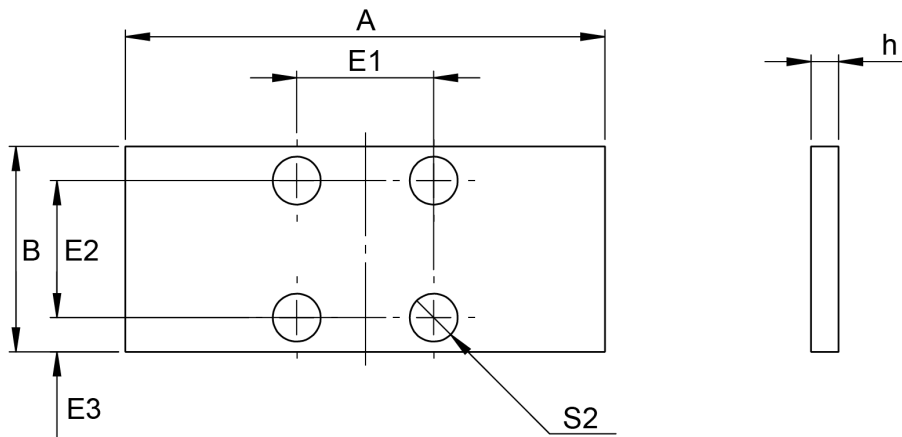

| Designation | A | B | S2 | E1 | E2 | E3 | h |
|-------------|-----|----|-----|----|----|-----|----|
| PHK15-4 | 47 | 24 | M4 | 17 | 17 | 3.5 | 4 |
| PHK25-4 | 70 | 30 | M6 | 20 | 20 | 5 | 4 |
| PHK30-3 | 90 | 39 | M6 | 22 | 22 | 8.5 | 3 |
| PMK35-7 | 100 | 39 | M8 | 24 | 24 | 7.5 | 7 |
| PHK45-10 | 120 | 44 | M10 | 26 | 26 | 9 | 10 |