

MK Clamping Element

Pneumatic clamping element, designed to be used for holding a position when using linear rail guides.
Energize to close (NO).

For other types contact Rollco.

Compatible with Linear Rail HRC/ARC/ERC only.

Dimensions in mm.

Temperature range (°C): 0 - 70



General Data

| Designation | Compatible with | Fixing force (N) | Operating pressure (bar) | Max. Operating Pressure (bar) | Installation way |
|----------------|-----------------|------------------|--------------------------|-------------------------------|------------------|
| MK1514D | HRC15, HRU15 | 650 | 6 | 6.5 | from above |
| MK2014D | HRC20, HRU20 | 700 | 6 | 6.5 | from above |
| MK2514D | HRC25, HRU25 | 1200 | 6 | 6.5 | from above |
| MK3005A | HRC30, HRU30 | 1750 | 6 | 6.5 | from above |
| MK3514D | HRC35, HRU35 | 2000 | 6 | 6.5 | from above |
| MK4514D | HRC45, HRU45 | 2250 | 6 | 6.5 | from above |

Dimensions

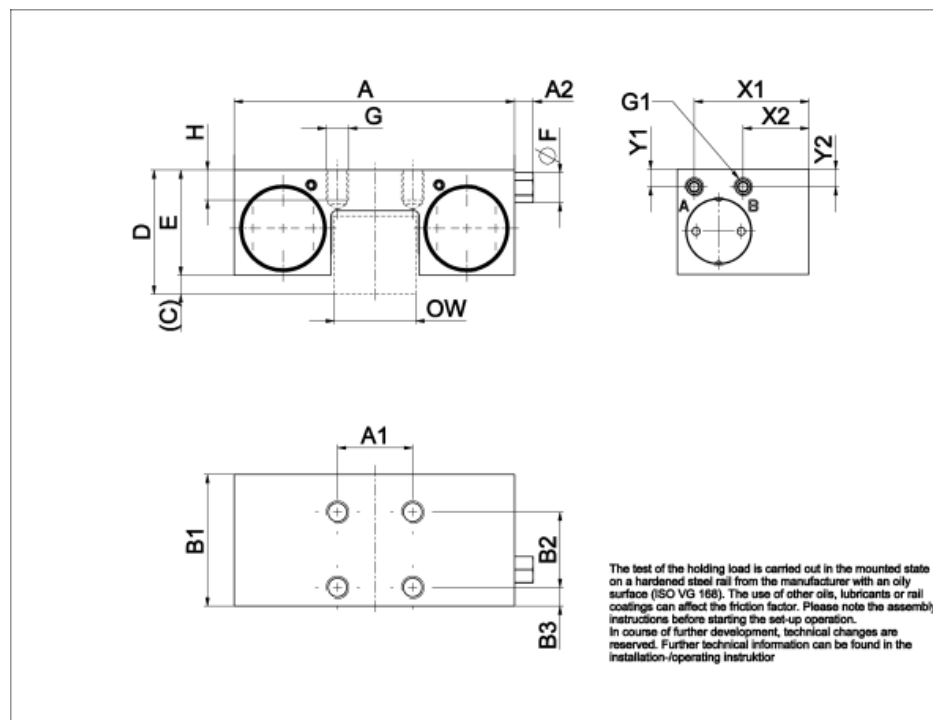

| Designation | OW | D | T | A | C | X | E | A1 | A2 |
|-------------|-------|----|---|-----|------|----|------|----|----|
| MK1514D | 13 | 24 | 0 | 55 | 2.5 | 24 | 21.5 | 15 | 5 |
| MK2014D | 16.75 | 30 | 2 | 66 | 3.5 | 28 | 24.5 | 20 | 6 |
| MK2514D | 19.75 | 36 | 0 | 75 | 8 | 36 | 28 | 20 | 5 |
| MK3005A | 24.6 | 42 | 0 | 90 | 7 | 42 | 35 | 22 | 5 |
| MK3514D | 31.8 | 48 | 0 | 100 | 11.5 | 48 | 36.5 | 24 | 5 |
| MK4514D | 42 | 60 | 0 | 120 | 16.5 | 60 | 43.5 | 26 | 5 |

| Designation | B1 | B2 | B3 | G | H | F | W1 (SW air filter) | G1 (air connection) | X1 (air filter horizontal / mm) | Y1 (air filter vertical / mm) |
|-------------|----|----|------|-----|-----|---|--------------------|---------------------|---------------------------------|-------------------------------|
| MK1514D | 39 | 15 | 15.5 | M4 | 4.5 | 8 | 7 | M5 | 34 | 17 |
| MK2014D | 39 | 20 | 10 | M5 | 4.2 | 8 | 7 | M5 | 35 | 21 |
| MK2514D | 35 | 20 | 5 | M6 | 8 | 8 | 7 | M5 | 30.5 | 4.7 |
| MK3005A | 39 | 22 | 8.5 | M8 | 7 | 8 | 7 | M5 | 24.5 | 5.2 |
| MK3514D | 39 | 24 | 7.5 | M10 | 10 | 8 | 7 | M5 | 20 | 5.2 |
| MK4514D | 49 | 26 | 11.5 | M10 | 15 | 8 | 7 | M5 | 29.5 | 11 |

| Designation | X2 (air connection horizontal / mm) | Y2 (air connection vertical / mm) |
|-------------|-------------------------------------|-----------------------------------|
| MK1514D | 34 | 6.1 |
| MK2014D | 34 | 5.2 |
| MK2514D | 17.5 | 4.7 |
| MK3005A | 14.5 | 5.2 |
| MK3514D | 9 | 5.2 |

Dimensions

| Designation | X2 (air connection horizontal / mm) | Y2 (air connection vertical / mm) |
|-------------|-------------------------------------|-----------------------------------|
| MK4514D | 19.5 | 11 |