

## Couplings

Dimension in mm.

The maximum transmittable torque of the clamping hub depends on the bore diameter.



Maximum transmittable and drive torque  $M_{b,c}$  [Nm] depends on the bore diameter [mm]

Designation	Ø3	Ø4	Ø5	Ø8	Ø10	Ø12,7
EKL 2	0,2	0,8	1,5	2,5	-	-
EKL 5	-	1,5	2	8	8	10

Maximum transmittable and drive torque  $M_{b,c}$  [Nm] limited to the size of the MCE/MSCE

Designation	MCE/MSCE		
	25	32	45
EKL 2	0,1	0,53	-
EKL 5	-	-	1,23

## General Data

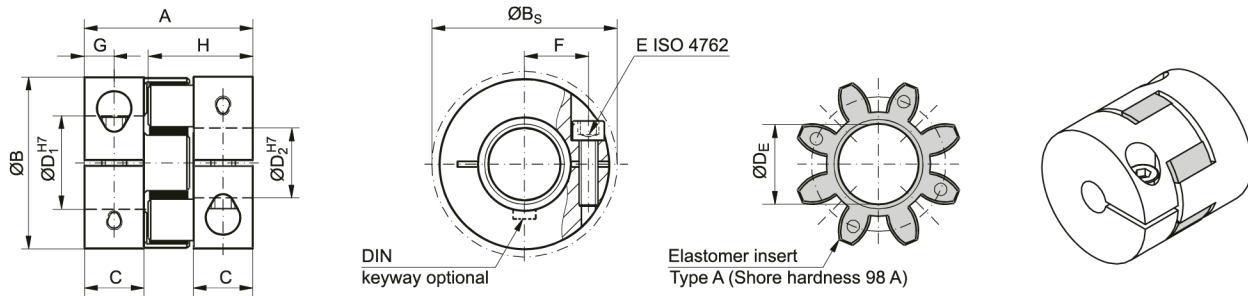

Designation	Rated Torque (Nm)	Max. Torque (Nm)	G	A	B
EKL 2	2	4	3	20	16
EKL 5	9	18	4	26	25

Designation	H	F	C	D1	D2	E
EKL 2	12	5.5	6	3	8	M2
EKL 5	16.7	8	8	4	12.7	M3

Designation	Tightening Torque of the Clamping Screw (Nm)	Compatible with	Moment of inertia per hub ( $10^{-3} \text{ kg m}^2$ )	Speed standard ( $\text{min}^{-1}$ )	BS	DE
EKL 2	0.6	MCE/MSCE series	0.0003	15000	17	6.2
EKL 5	2	MCE/MSCE 45	0.002	15000	25	10.2

Designation	Weight (kg)
EKL 2	≈ 0.008
EKL 5	≈ 0.02