

Bracket 60 × 60

Material: Bracket: Uncoated die-cast zinc

Cap: Black plastic (PA)

Slot 6 mounting material:

8× M6 slot 6 slot nuts with step

8× M6 × 14 screw (DIN 7380)

Slot 12 mounting material:

8× M8 slot 12 slot nuts with step

8× washer (DIN 125)

8× M8×28 screw (DIN7380)

System: 30 - Slot 6

Type: Angles Brackets and Corners; Fasteners

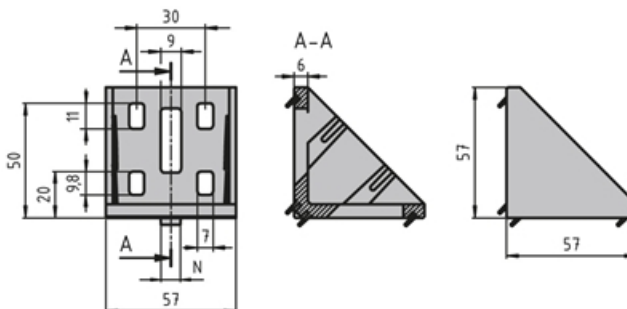

| | | |
|-----------------|--------------------|--------------------|
| | | |
| Fmax (N) | Mmax 1 (Nm) | Mmax 2 (Nm) |
| 2000 | 100 | 120 |

General Data

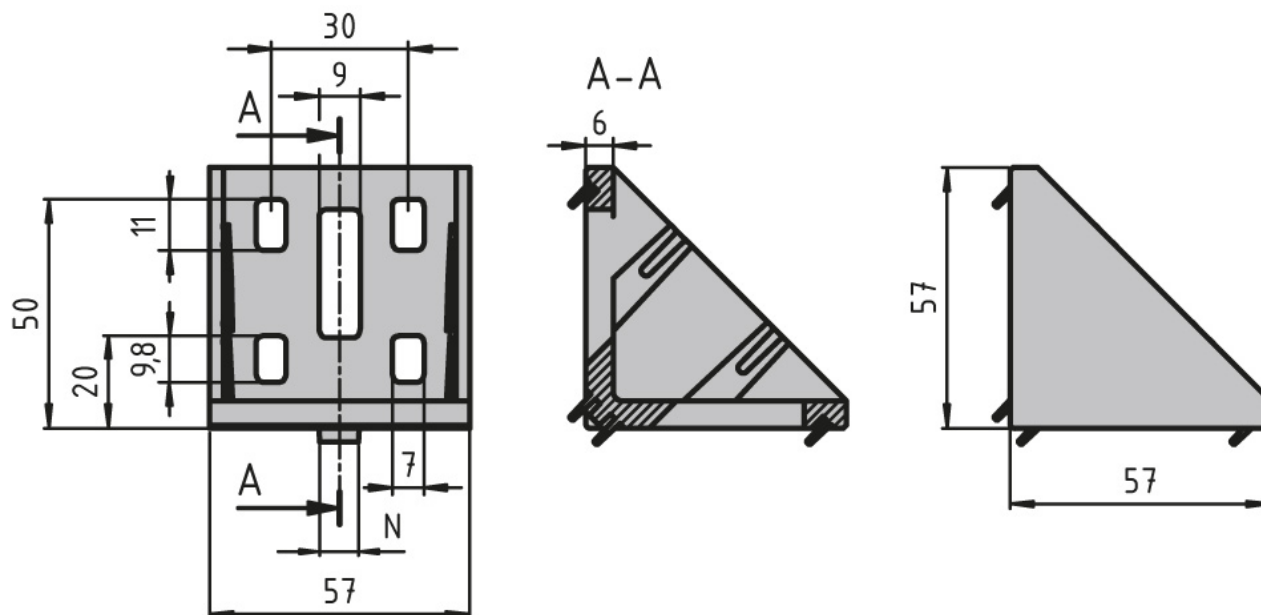

| Designation | Description | System | ESD |
|----------------|--|-------------|-----|
| PZ5010 | Bracket 60 × 60 | 30 - Slot 6 | - |
| PZ5011 | Bracket 60 × 60 with mounting material and ABDK | 30 - Slot 6 | Yes |
| PZ5012 | Bracket 60 × 60 silver powder coated with mounting material and ABDK | 30 - Slot 6 | - |
| PA1205 | Cap 60 × 60 | 30 - Slot 6 | - |
| PZ5013 | Bracket 60 × 60 with mounting material and ABDK | 30 - Slot 6 | Yes |
| SZ0967N | Corner Bracket Zn 30 x 30 | 30 - Slot 6 | - |
| SZ0965N | Corner Bracket Zn 20 x 20 | 30 - Slot 6 | - |
| SZ0964N | SZ0964N Corner bracket ZN 20x20 Set | 30 - Slot 6 | - |