

Door Stop, top round (excentric)

Application:

Upper door stop with excentric adjustment and o-ring cushioning.

Supply:

1x cap head screw M 8 x 45

1x t-nut M 8 / ball-type, slide-in

Material: POM, black

System: 40 - Slot 8

Type: Magnetic Catch Plates & Door Stops

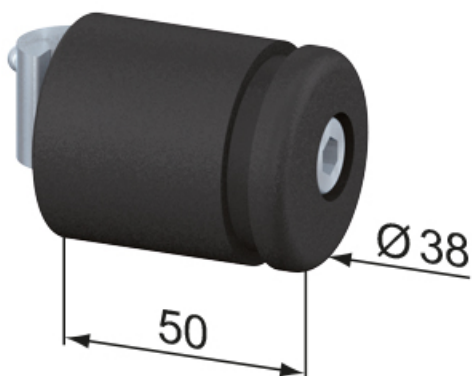

General Data

Designation	Description	System	Weight (g)
SZ8042S	Door Stop, top, round (excentric)	40 - Slot 8	94