

Door Stops, bottom

Supply:

2x SS9900V anti-twist set screw

1x countersink screw M8 x 25

System: 40 - Slot 8

Type: Magnetic Catch Plates & Door Stops

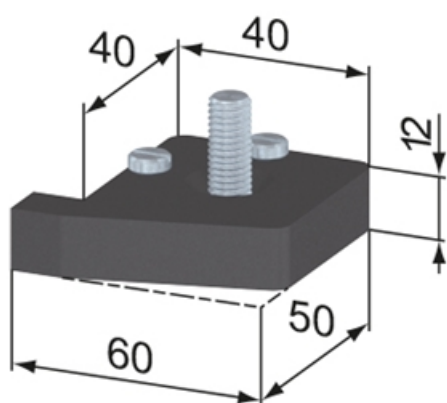
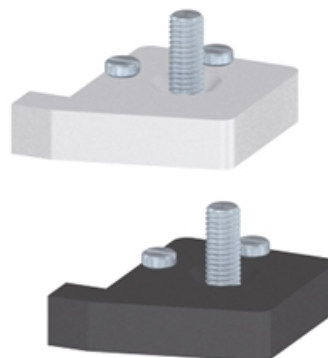

SZ8041S

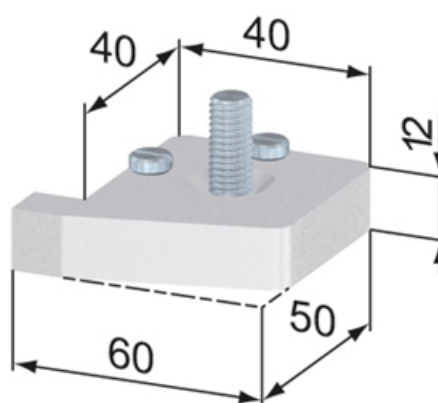

SZ8041N

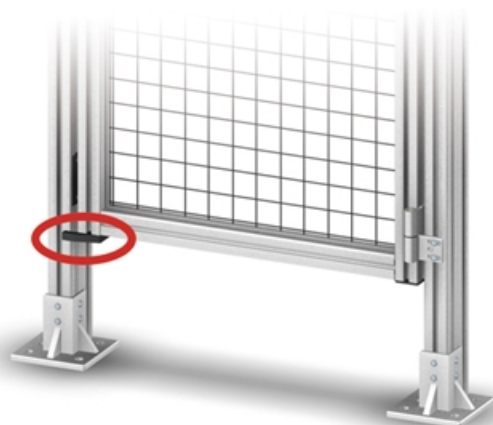

General Data

| Designation | Description | System | Material | Weight (g) |
|----------------|------------------------------|-------------|-----------------------------|------------|
| SZ8041S | Door Stop, bottom (POM) | 40 - Slot 8 | POM, black | 43 |
| SZ8041N | Door Stop, bottom (aluminum) | 40 - Slot 8 | Aluminium, natural anodized | 70 |